

Banksia / Zachary Hanna

Named after the vibrant reds, rich yellows and deep oranges of the Australian native flower, Banksia is an oil lamp designed to accompany entertaining outdoors. Banksia's glass diffuser creates a soft glow that dances and reflects upon the spun aluminium frame, offering light, ambience and even optional insect repelling oils. Resting within a sculptural cage that doubles as a handle for convenient movement, Banksia is a lively and captivating alternative to portable LED Lamps.

## Banksia Oil Lamp

outdoor lighting

### Instruction Manual

By Zachary Hanna

n  
a  
u

[naudesign.com.au](http://naudesign.com.au)

Sydney.  
21-23 Levey Street  
Chippendale NSW 2008  
[info@cultdesign.com.au](mailto:info@cultdesign.com.au)  
P +61 2 8062 6000

Brisbane.  
925 Ann Street  
Fortitude Valley QLD 4006  
[info@cultdesign.com.au](mailto:info@cultdesign.com.au)  
P +61 7 3252 7605

Melbourne.  
680 Elizabeth Street  
Melbourne VIC 3000  
[info@cultdesign.com.au](mailto:info@cultdesign.com.au)  
P +61 3 9066 1177

Auckland.  
73 The Strand  
Parnell Auckland 1010  
[info@cultdesign.co.nz](mailto:info@cultdesign.co.nz)  
P +64 9 379 4466

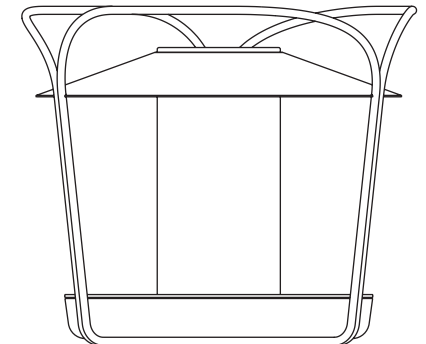

## INSTRUCTIONS

Thread the wick through the wickholder and ensure it is not raised outside the wickholder as this will cause the wick to smoke. Pull the bottom of the wick through the burner and through the opening to ensure it is resting in the oil.

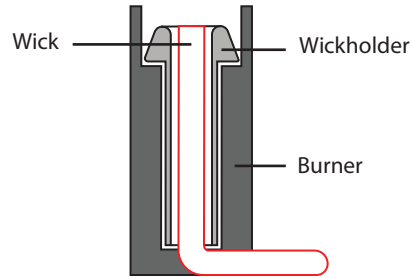

To fill the reservoir, lift the glass tube upward to remove. Remove the wick, wickholder and burner before tilting the lid upward to fill the reservoir approx 1/2 full. Then place the wickholder and glass back in position.

To light, lift the glass tube upward to allow access to the wick and light using a lighter. Once lit, the glass can be lowered back into position.

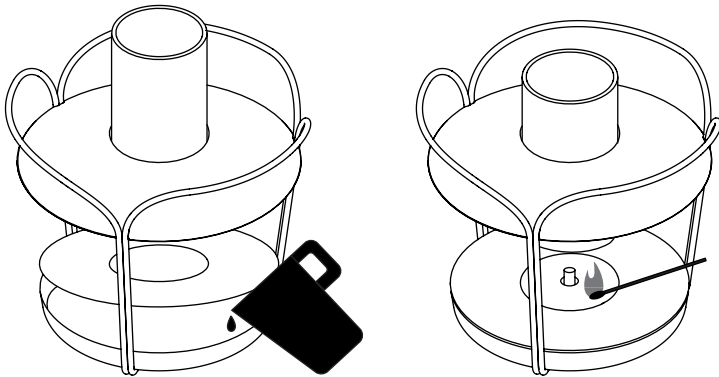

## OIL LAMP SAFETY

We recommend for OUTDOOR use only. As with any natural flame products, there is an inherent risk. Never leave a lit torch unattended.

Do not burn on or near any material or surface which is flammable, heat sensitive or porous as the flame may cause damage. Do not burn near or under electrical appliances or flammable objects such as wood structures, fuel, clothing, dry vegetation. Do not use liquids to extinguish.

NEVER use petrol or gasoline, only use designated Lamp or Citronella Torch Oils.

## WHEN IN USE

Do not attempt to move while alight, extinguish flame before moving lamp. Do not tilt lamp.

Always keep lamp & oil out of reach of children & pets.

Before lighting, allow wick to become saturated with oil (the oil will draw up the wick & become wet). Do not set wick higher than 5mm above the top of the steel tube. The size of the flame can be controlled by the amount of wick exposed. If too much smoke is being produced, pull wick back through holder so less wick is exposed.

## AFTER USE

Do not touch glass after use. Blow down top of glass tube or use a snuffer to cover mouth of glass tube and starve flame of oxygen. Allow to cool for at least 30 mins or more before handling.

Store cooled lamp away from exposed weather conditions when not in use, do not allow wick to be contaminated with water.